

SPECIFICATIONS

Rated(额定参数): 300V,1.5A
 Dielectric strength(抗电强度): AC2000V/1 Minute
 Insulation Resistance(绝缘电阻):1000MΩ Min
 Contact Resistance(接触电阻):20mΩ Max
 Screw Torque(扭矩): 0.4Nm (3.5Lb.in)
 Wire Range(线径):22~14AWG
 Strip length(剥线长度):5~6mm
 Temp. range(操作温度): -40℃~+105℃
 MAX Soldering(瞬时温度):+250℃,5s

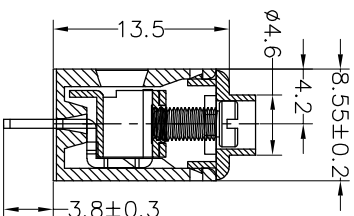
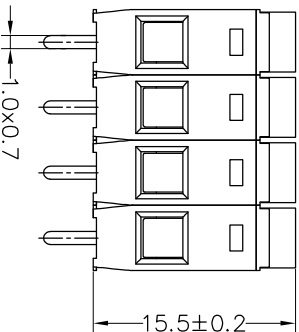
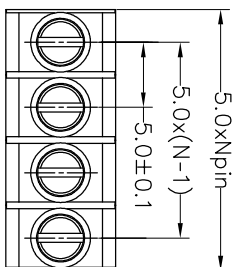

PITCH RANGE IN MM	NOMINAL DIMENSION RANGE IN MM			
	OVER	OVER	OVER	OVER
TO 6	10	TO 30	60	TO 100
TO 10	TO 24	TO 30	TO 60	TO 100
TO 10	TO 24	TO 60	TO 100	TO 150
±0.10	±0.15	±0.25	±0.30	±0.50
				±0.70
				±1.00

Housing Material(塑件): PA66 (UL94 V-0)
 Contact(端子): Brass, Tin plating(黄铜镀锡)
 Clamp(方块): Brass/Steel(铜/铁), Ni plating(镀镍)
 Screw (螺丝): M2.5, Steel, Zinc plating(钢,镀锌)

Ordering Information

JL 169 - 500 XX X X 1

Pitch 500=5.0PH
 No.of pins 2P,3P,4P~24P
 Housing Color
 B=Black
 G=Green
 U=Blue
 R=Red
 W=White
 Y=Yellow
 O=Orange
 E=Grey
 Packing
 0=Pe bog
 T=Tube
 A=Tray

Recommended P.C.B Layout(Top Side)

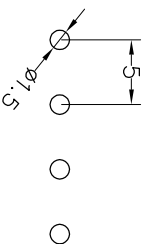

REV	DATE	MODIFICATION DESCRIPTION	CHANGE	OPERATION		DRAW	BEN	17.01.04	SCALE		FIT	PROU.	TITLE:
				XX	±0.30				UNIT	mm			
A0	2017.01.04	NEW DRAWING		X:XX	±0.20	CHECK			SIZE	A4			PART NO. JL169-500XXXXX1
				X:XXX	±0.10				SHEET	1/1			5.00mm Terminal Blocks Female 180°
1				Angle	±3°	APPROVE							

JIN 深圳市锦凌电子有限公司
 SHENZHEN JINLING ELECTRONIC CO.,LTD
 Tel: 86-755-2997-5806/5802 Fax: 86-755-2997-5992